

## Wired or Wireless Connection Circuit?

There are two common ways to connect your photo finish system to the start detection and peripherals, via a wired cable system or a wireless radio transmitter and receiver.

Justiming offers products that are connect via TimeTronics wired cable system, therefore allowing for guaranteed results.

### **Practically the best**

When Justiming was first looking to supply photo finish products to the U.K., we ourselves initially favoured the theory of a wireless system, however when you delve into the use and practicalities, a wired cable network soon become our first choice. Let me explain.

You want results guaranteed. Nobody wants to revert to hand times and you cannot ask the athletes to run again! In short you only get one chance to capture the finish line picture and with a wireless circuit, you run the risk of radio



frequency disturbance (from other radios, mobiles or the atmosphere) interfering with transmission of signals, leading to an image not being created. Nothing is as reliable as copper caballing, and by means of a single cable around the track, you can connect all TimeTronics equipment.

Justiming supplies a mobile cable system or an underground fixed cable system.

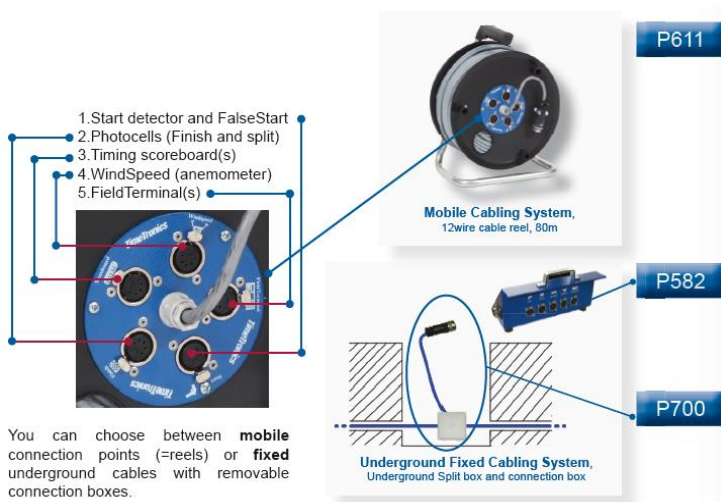

Now here comes the good part.

You may think that to set up a wired system would take far longer than a wireless system. Incorrect. Due to the unique software within the MacFinish 2D USB camera, finding the finish line can take far less time than other branded photo finish systems, therefore allowing you to gain back the time that you spent laying out the cables.

### **Rely on the finest**

Overall photo finish timing is all about reducing the risk of you not capturing the finish line image; after all you only have one chance! Wired caballing gives you the most dependable circuit possible, with minimal set up period.

***TimeTronics wired caballing system,  
simple and reliable.***

# Justiming